

TOSHIBA

3.1CH Soundbar with Wireless Subwoofer

Model: M310WR

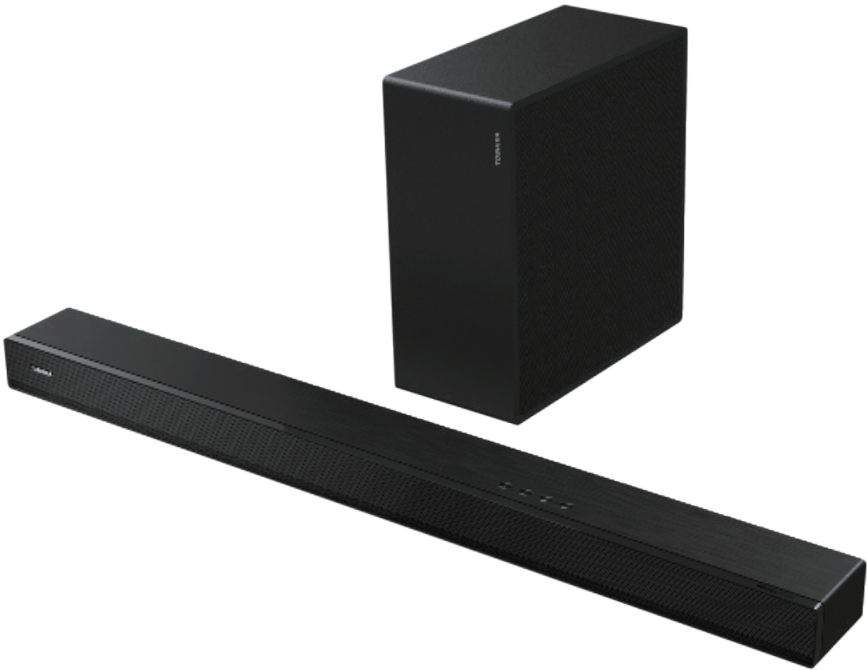

 **Dolby Atmos**

 **Bluetooth®**

HDMI™
HIGH-DEFINITION MULTIMEDIA INTERFACE

dts x™

USER MANUAL



Before using the soundbar, please read this manual thoroughly and retain it for future reference.

Contents

1. Important Safety Instructions	3
1.1 Safety	3
1.2 Caution	4
1.3 Warning	4
2. What's in the Box	5
3. Identifying the Parts	6
3.1 Soundbar	6
3.2 Wireless Subwoofer	6
3.3 Remote Control	7
4. Preparations	7
4.1 Prepare the Remote Control	7
4.2 Replace the Remote Control Battery	7
5. Placement and Mounting	8
5.1 Placement	8
5.2 Wall Mounting the Soundbar	8
6. Connections	9
6.1 Use the HDMI eARC/ARC Socket	9
6.2 Use the Easy Control Function	9
6.3 REGZA AI Sound Harmonizer function	10
6.4 Use the OPTICAL Socket	10
6.5 Use the AUX Socket	10
6.6 Connect Power	10
7. Pair up with the Subwoofer	11
8. Basic Operation	12
8.1 Standby/On	12
8.2 Auto-Standby / Auto-Wake Feature	12
8.3 Select Input Source	12
8.4 Adjust the Volume	12
8.5 Turn the Surround PURE/PRO/OFF	12
8.6 Adjust the Bass/Treble	12
8.7 Select Equalizer (EQ) Effect	13
8.8 Adjust the Brightness	13
8.9 Factory reset	13
9. HDMI eARC/ARC, OPTICAL, AUX	13
10. USB Operation	13
11. Bluetooth® Operation	14
12. Setup Menu	14
13. Troubleshooting	15
14. Specifications	16

1. Important Safety Instructions





The lightning flash with arrowhead symbol, within an equilateral triangle, is intended to alert the user to the presence of uninsulated "dangerous voltage" within the product's enclosure that may be of sufficient magnitude as to constitute a risk of electric shock to persons.



The exclamation point within an equilateral triangle is intended to alert the user to the presence of important operating and maintenance (servicing) instructions in the literature accompanying the appliance.

1.1 Safety

- 1 **Read these instructions** – All the safety and operating instructions should be read before this product is operated.
- 2 **Keep these instructions** – The safety and operating instructions should be retained for future reference.
- 3 **Heed all warnings** – All warnings on the appliance and in the operating instructions should be adhered to.
- 4 **Follow all instructions** – All operating and usage instructions should be followed.
- 5 **Do not use this apparatus near water** – The appliance should not be used near water or moisture – for example, in a wet basement or near a swimming pool and the like.
- 6 **Clean only with a dry cloth.**
- 7 **Do not block any ventilation openings.** Install in accordance with the manufacturer's instructions.
- 8 Do not install near any heat sources such as radiators, heaters, stoves, or other apparatus (including amplifiers) that produce heat.
- 9 Do not defeat the safety purpose of the polarized or grounding plug. A polarized plug has two blades with one wider than the other. A grounding plug has two blades and a third grounding prong. The wide blade or the third prong is provided for your safety.
- 10 Protect the power cord from being walked on or pinched particularly at plugs, convenience receptacles, and the point where they exit from the apparatus.
- 11 Only use attachments/accessories specified by the manufacturer.
- 12  Use only with the cart, stand, tripod, bracket or table specified by the manufacturer, or sold with the apparatus. When a cart or rack is used, use caution when moving the cart/apparatus combination to avoid injury from tip-over.
- 13 Unplug the apparatus during lightning storms or when unused for long periods of time.
- 14 Refer all servicing to qualified personnel. Servicing is required when the apparatus has been damaged in any way, such as power supply cord or plug is damaged, liquid has been spilled or objects have fallen into the apparatus, the unit has been exposed to rain or moisture, does not operate normally, or has been dropped.
- 15  This equipment is a Class II or double insulated electrical appliance. It has been designed in such a way that it does not require a safety connection to electrical earth.
- 16 The apparatus shall not be exposed to dripping or splashing. No objects filled with liquids, such as vases, shall be placed on the apparatus.
- 17 Minimum distance around the apparatus for sufficient ventilation is 5cm.
- 18 The ventilation should not be impeded by covering the ventilation openings with items, such as newspapers, table-cloths, curtains, etc.
- 19 No naked flame sources, such as lighted candles, should be placed on the apparatus.
- 20 Batteries should be recycled or disposed of as per state and local guidelines.
- 21 The use of apparatus in moderate climates.

1.2 Caution

- Use of controls or adjustments or performance of procedures other than those described herein, may result in hazardous radiation exposure or other unsafe operation.
- To reduce the risk of fire or electric shock, do not expose this apparatus to rain or moisture. The apparatus must not be exposed to dripping or splashing and objects filled with liquids, such as vases, must not be placed on apparatus.
- The mains plug/appliance coupler is used as the disconnect device, the disconnect device must remain readily operable.
- Danger of explosion if battery is incorrectly replaced. Replace only with the same or equivalent type.

1.3 Warning

- The battery (batteries or battery pack) shall not be exposed to excessive heat such as sunshine, fire or the like.
- Before operating this system, check the voltage of this system to see if it is identical to the voltage of your local power supply.
- Do not place this unit close to strong magnetic fields.
- Do not place this unit on the amplifier or receiver.
- If any solid object or liquid falls into the system, unplug the system and have it checked by qualified personnel before operating it any further.
- Do not attempt to clean the unit with chemical solvents as this may damage the finish. Use a clean, dry or slightly damp cloth.
- When removing the power plug from the wall outlet, always pull directly on the plug, never yank on the cord.
- Changes or modifications to this unit not expressly approved by the party responsible for compliance will void the user's authority to operate the equipment.
- The rating label is pasted on the bottom or back of the equipment.

- Do not mix alkaline, standard (Carbon-Zinc) or rechargeable (Ni-Cd, Ni-MH, etc.) batteries.
- Remove batteries when the unit is not used for a long time.

WARNING:

- Replacement of a battery with an incorrect type may defeat a safeguard;
- Disposal of a battery into fire or a hot oven, or mechanically crushing or cutting of a battery, may result in an explosion;
- Leaving a battery in an extremely high temperature surrounding environment, such as sunshine, fire, or hot surface may result in an explosion or the leakage of flammable liquid or gas;
- A battery subjected to extremely low air pressure may result in an explosion or the leakage of flammable liquid or gas.

CAUTION: Risk of fire or explosion if the battery is replaced by an incorrect type!



Correct Disposal of this product. This marking indicates that this product should not be disposed with other household wastes throughout the EU. To prevent possible harm to the environment or human health from uncontrolled waste disposal, recycle it responsibly to promote the sustainable reuse of material resources. To return your used device, please use the return and collection systems or contact the retailer where the product was purchased. They can take this product for environmental safe recycling.

Hereby, XinYang (Hong Kong) Co., Ltd. Declares that the radio equipment type is in compliance with Directive 2014/53/EU and Radio Equipment Regulations 2017 of UK.



Battery usage CAUTION

To prevent battery leakage which may result in bodily injury, property damage, or damage to the apparatus:

- Install all batteries correctly, + and - as marked on the apparatus.
- Do not mix old and new batteries.

2. What's in the Box

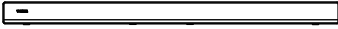

Soundbar

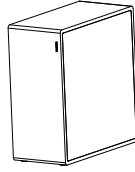

Wireless Subwoofer

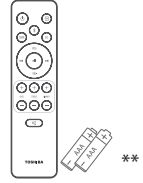

Remote Control /
AAA Batteries x 2

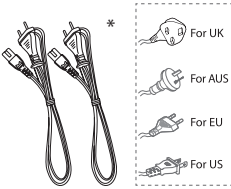

AC Power Cord x 2

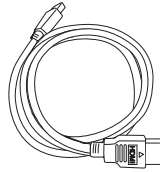

HDMI Cable

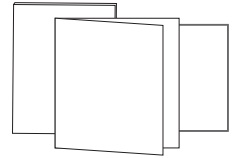

User Manual/Warranty card
/Quick start guide

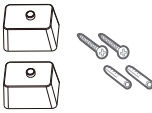

Brackets (x2) /Bracket Screw (x2)
/ Wall Anchors (x2)

- Power cord quantity and plug type vary by regions. ** The accessories may be different from the list above due to different models, countries/ regions, please refer to the actual accessory bag.
- Images, illustrations and drawings shown on this User Manual are for reference only, actual product may vary in appearance.

3. Identifying the Parts

3.1 Soundbar

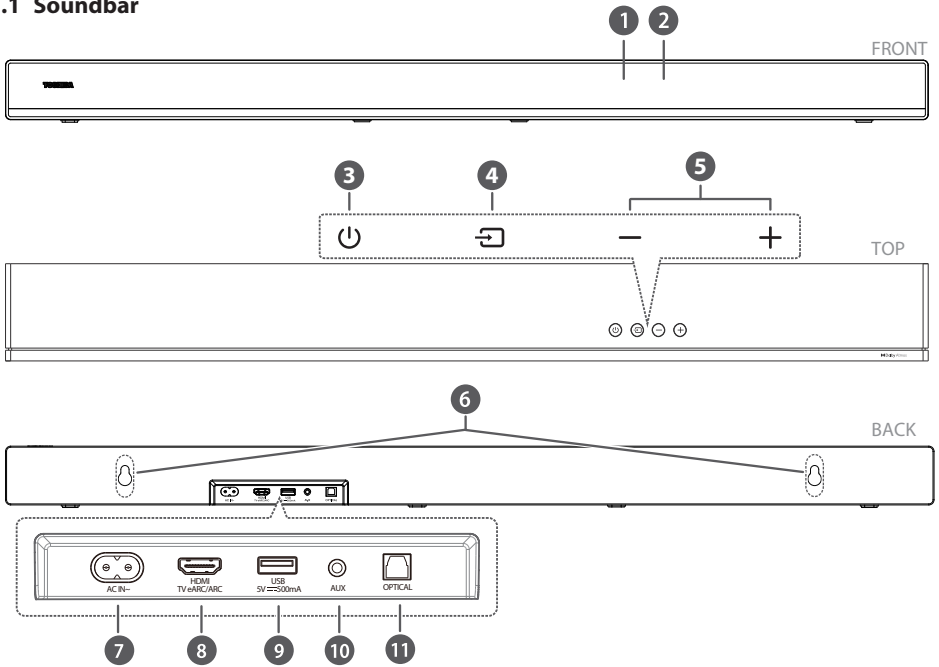

1 Display Window

Show the current status.

2 Remote Control Sensor

Receive signal from the remote control.

3 ⏻ (ON/OFF) button

Switch the soundbar between On and Standby mode.

4 📺 (SOURCE) button

Select the input source.

5 +/- (VOL) buttons

Increase/decrease the volume level.

6 Wall Mount

7 AC IN ~ Socket

Connect an AC power cord.

8 HDMI TV eARC/ARC Socket

Connect to a TV via HDMI cable.

9 USB Socket

Insert the USB device to play music.

10 AUX Socket

11 OPTICAL Socket

3.2 Wireless Subwoofer

1 Pairing Indicator

Light stops blinking once the subwoofer is paired with the soundbar.

2 PAIR button





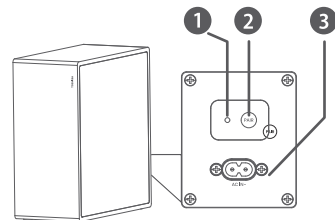

Activate the pairing function between the soundbar and subwoofer.

3 AC IN~ Socket

Connect an AC power cord.



3.3 Remote Control

-  Switch the soundbar between ON and STANDBY mode.
- SURR** Switch the surround PURE/PRO/OFF. Press and hold to adjust surround sound level.
- VOL+ /VOL-** Increase/decrease the volume level.
- BASS +/-** Adjust bass level.
-  (MUTE) Mute or resume the sound.
-  (SOURCE) button Select the input source.
-  Select the Bluetooth mode.
Press and hold to activate the pairing function in Bluetooth mode or disconnect the existing paired Bluetooth device.
Select MOVIE/MUSIC/GAME/NEWS/SPORT /NIGHT/AI
- EQ** Select MOVIE/MUSIC/GAME/NEWS/SPORT /NIGHT/AI
-  /  Skip to previous/next track in Bluetooth/USB mode.
-  Play/pause/resume playback in Bluetooth/USB mode. Press and hold the button for 3s to enter setup menu.
- DIMMER +/-** Adjust LED brightness.
- TREBLE +/-** Adjust treble level.

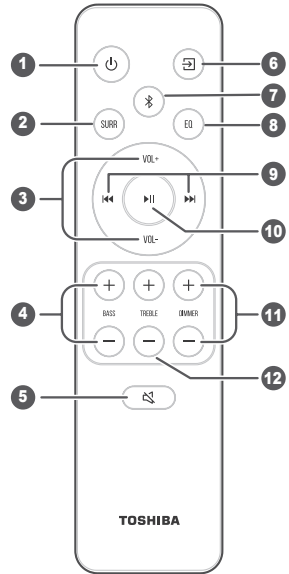

4. Preparations

4.1 Prepare the Remote Control

The provided Remote Control allows the soundbar to be operated from a distance.

- Even if the Remote Control is operated within the effective range 19.7 feet (6m), remote control operation may be impossible if there are any obstacles between the soundbar and the remote control.
- If the Remote Control is operated near other products which generate infrared rays, or if other remote control devices using infrared rays are used near the soundbar, it may operate incorrectly. Conversely, the other products may operate incorrectly.

4.2 Replace the Remote Control Battery

- 1 Press and slide the back cover to open the battery compartment of the remote control.
- 2 Insert two **AAA** size batteries. Make sure the (+) and (-) ends of the batteries match the (+) and (-) ends indicated in the battery compartment.
- 3 Close the battery compartment cover.

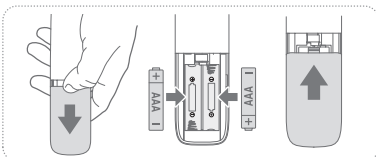

Precautions Concerning Batteries

- Be sure to insert the batteries with correct positive “+” and negative “-” polarities.
- Use batteries of the same type. Never use different types of batteries together.
- Either rechargeable or non-rechargeable batteries can be used. Refer to the precautions on their labels.
- Be aware of your fingernails when removing the battery cover and the battery.
- Do not drop the remote control.
- Do not allow anything to impact the remote control.
- Do not spill water or any liquid on the remote control.
- Do not place the remote control on a wet object.
- Do not place the remote control under direct sunlight or near sources of excessive heat.
- Remove the battery from the remote control when not in use for a long period of time, as corrosion or battery leakage may occur and result in physical injury, and/or property damage, and/or fire.
- Do not use any batteries other than those specified.
- Do not mix new batteries with old ones.
- Never recharge a battery unless it is confirmed to be a rechargeable type.

5. Placement and Mounting

5.1 Placement

- A If your TV is placed on a table, you can place the soundbar on the table directly in front of the TV stand, centered with the TV screen.
- B If your TV is attached to a wall, you can mount the soundbar on the wall directly below the TV screen.

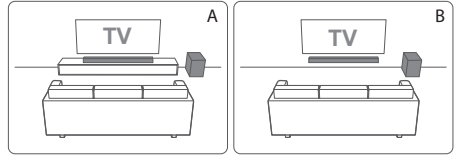

5.2 Wall Mounting the Soundbar

- Installation must be carried out by qualified personnel only. Incorrect assembly can result in severe personal injury and property damage (if you intend to install this product yourself, you must check for installations such as electrical wiring and plumbing that may be buried inside the wall). It is the installer's responsibility to verify that the wall will safely support the total load of the soundbar and wall brackets.
- Additional tools (not included) are required for the installation.
- Do not overtighten screws.
- Keep this instruction manual for future reference.
- Use an electronic stud finder to check the wall type before drilling and mounting.

WARNING

- To prevent injury, this unit must be securely attached to the floor/wall in accordance with the installation instructions.
 - Suggested wall mounting height: ≤ 1.5 meters.
1. Drill 2 parallel holes ($\varnothing 5.5$ -6 mm each according to wall type) in the wall. The distance between the holes should be 668.5 mm / 26.3".
 2. Insert the supplied wall anchors into 2 screw holes on the wall. Insert the supplied wall bracket screws through the wall brackets into the wall anchors. Fix and tighten the screws on the wall.
 3. Hang the Soundbar on the wall mount brackets.

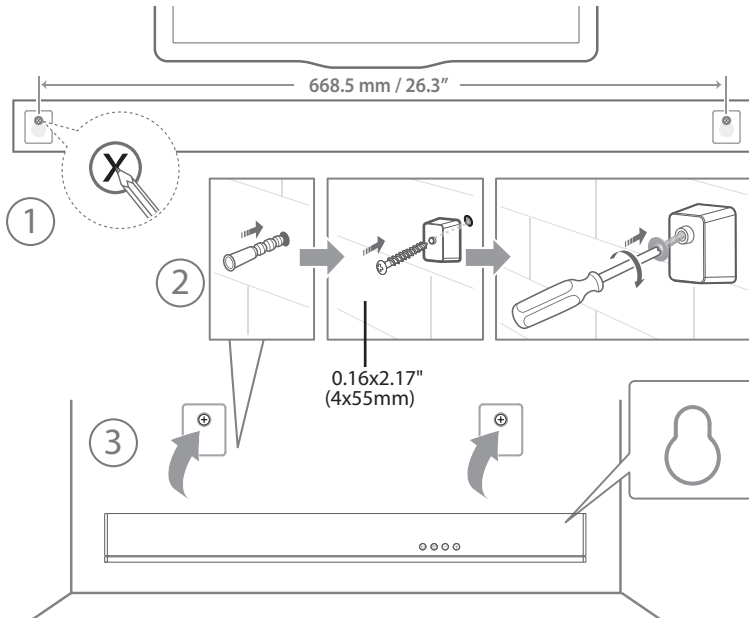

6. Connections

6.1 Use the HDMI eARC/ARC Socket

The eARC/ARC (Enhanced Audio Return Channel) function allows you to send audio from your ARC-compliant TV to your soundbar through a single HDMI connection. To enjoy the ARC function, please ensure your TV is both HDMI-CEC and ARC compliant and set up accordingly. When correctly set up, you can use your TV remote control to adjust the volume output (VOL+/- and MUTE) of the soundbar.

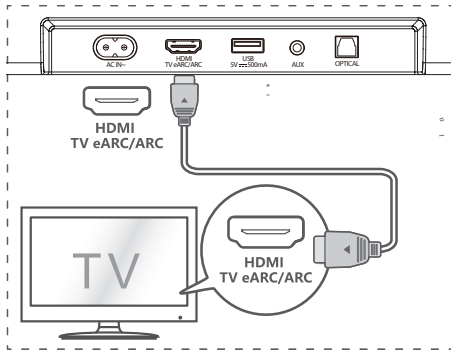

- Connect the HDMI cable from soundbar **HDMI TV eARC/ARC** socket to the HDMI eARC/ARC socket on your ARC compliant TV. Then press the remote control to select **HDMI eARC/ARC**.

Tips:

- Your TV must support the HDMI-CEC and ARC function. HDMI-CEC and ARC must be set to On.
- The setting method of HDMI-CEC and ARC may differ depending on the TV. For details about **eARC/ARC** function, please refer to the owner's manual.
- Only HDMI 1.4 or higher version cable can support the ARC function.

6.2 Use the Easy Control Function

For Easy Control, when the Soundbar connects with a TOSHIBA TV via HDMI eARC/ARC, there will be a Soundbar Setting menu on the TV, and you can control this menu via your TV remote to control most of the Soundbar features.

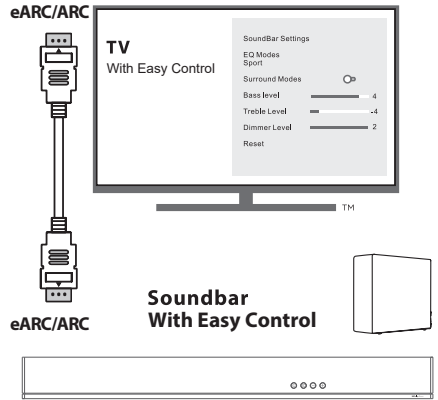

TV menu example (different models may have different menus) :

Setting--Sound--Soundbar Setting.

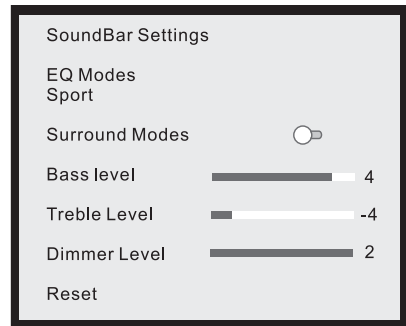

Note:

- This function is available only when both Soundbar and TV support TOSHIBA Easy Control.
- This function requires Soundbar and TV connected via HDMI eARC/ARC, and the CEC of the TV must be turned ON.
- If everytime setting right, for the first time connect, there would be a tip on the TV screen to guide you find the Soundbar setting menu.

6.3 REGZA AI Sound Harmonizer function

When connected to a TOSHIBA TV that supports REGZA AI Sound Harmonizer function, the soundbar plays audio in sync with the TV, enhancing your sound experience by providing a richer and more immersive auditory soundscape.

To use this function, when the soundbar is connected to the TV for the first time, simply select the "TV Speaker with Soundbar (REGZA AI Sound Harmonizer)" option from the Audio Output menu of the TV.

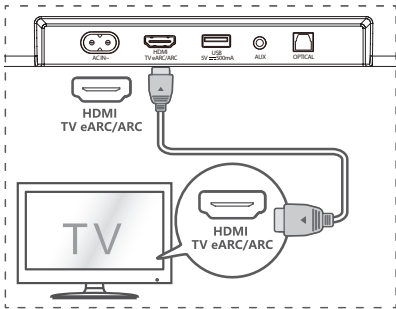

NOTE:

- This function is only supported in eARC mode, so please make sure the TV's eARC function is enabled.
- The message displayed may differ with the TV model.
- Ensure that the TV and soundbar are connected with an HDMI cable.
- This function is available in some TOSHIBA TV and some soundbar models.

6.4 Use the OPTICAL Socket

- Use the OPTICAL cable to connect the TV's OPTICAL OUT socket and the **OPTICAL** socket on the soundbar.

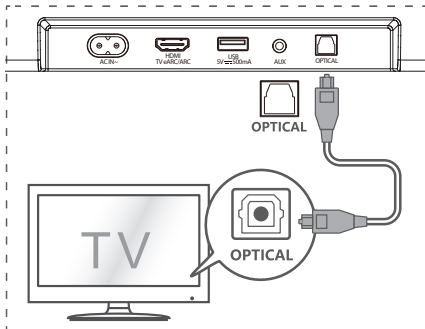

Tip:

The Soundbar may not be able to decode all digital audio formats from the input source. In this case, the Soundbar will mute. This is NOT a defect. Ensure that the audio setting of the input source (e.g., TV, game console, DVD player, etc.) is set to **PCM** or **Dolby Digital** (Refer to the user manual of the input source device for its audio setting details) with HDMI eARC/ARC / OPTICAL input.

6.5 Use the AUX Socket

- A. Use a 3.5mm to 3.5mm audio cable to connect the TV's or external audio device headphone socket to the **AUX** socket on the soundbar.

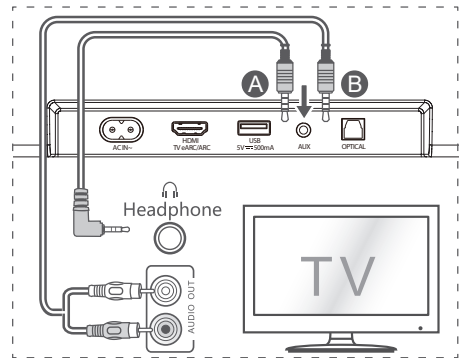

- B. Use a RCA to 3.5mm audio cable to connect the TV's audio output sockets to the **AUX** socket on the soundbar.

6.6 Connect Power

Risk of product damage!

- Risk of product damage! Ensure that the power supply voltage corresponds to the voltage printed on the back or the underside of the soundbar.
- Before connecting the AC power cord, ensure you have completed all other connections.
- **Soundbar**
Connect the mains cable to the AC~ socket of the soundbar and then into a mains socket.

- **Subwoofer**

Connect the mains cable to the AC~ socket of the subwoofer and then into a mains socket.

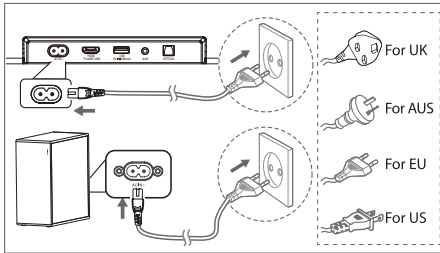

* Power cord quantity and plug vary by regions.

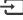
- 4 Press and hold the  button on the Soundbar or on the remote control for a few seconds to enter pairing mode. The display will scroll "**SW PAIRING**".
- 5 After the wireless connection succeeded, the Pair indicators will light up and the display on the Soundbar will show "**SW IN**".
- 6 If the Pair indicator blinks, the wireless connection has failed. Unplug the cable of the Subwoofer and then reconnect the main cable after 3 minutes. Repeat step 1 ~ 4.

Tips

- If the wireless connection fails again, check if there is a conflict or strong interference (e. g. interference from an electronic device) around the location. Remove these conflicts or strong interferences and repeat the above procedures.
- The Subwoofer should be within 6 meters of the Soundbar in an open area.
- If the Soundbar is in On mode, and not connected with the subwoofer the indicators on the subwoofer will flash slowly. Follow step 1~4 above to pair the subwoofer and the to the Soundbar.

7. Pair up with the Subwoofer

Automatic pairing

The subwoofer will pair automatically with soundbar upon first use.

- Determine the status based on the wireless Subwoofer indicator.

LED State	Status
Fast blink	Subwoofer in pairing mode
Constant on	Connected / Pairing successful
Slow blink	Connection / Pairing Failed

NOTE:

- Do not press the **Pair** button on the rear of the subwoofer, except for manual pairing.
- If the automatic pairing fails, pair the subwoofer with the soundbar manually.

Manual Pairing

- 1 Ensure that all cables are well connected and the Soundbar is in Standby mode.
- 2 Press the  button on the Soundbar or remote control to switch the Soundbar on.
- 3 Press and hold the **PAIR** button on the Subwoofer for a few seconds. The Subwoofer enter the pairing mode. The Pair indicator on the Subwoofer will blink quickly.

8. Basic Operation

8.1 Standby/On

It will automatically turn on when the power cord is connected.



- Press the  button to switch the soundbar to Standby mode.
- Disconnect the mains plug from the mains socket if you want to switch the soundbar Off completely.

8.2 Auto-Standby / Auto-Wake Feature

[Auto-Standby] During Auto Standby On mode, the soundbar would standby automatically when no audio is detected for 15 minutes. For example, this would happen when pausing playback, or should the soundbar be left on accidentally.

[Auto-Wake] If a TV or an external device is connected (AUX / OPTICAL / HDMI eARC mode), the unit will switch on automatically when the TV or the external device is switched on.

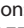
To disable this feature, please follow the steps below:



1. During ON mode, press and hold the  button for 3 seconds to open the menu. The unit's display will show "MENU".
2. Press the  button 6 times in succession: the display shows: **Auto Wake [ON / OFF]**.
or Press the  button 7 times in succession: the display shows: **Auto Standby [ON / OFF]**.
3. Select the content with **VOL+ / -** buttons on the remote control, and then press the  button to confirm your selection and exit the settings.
4. Repeating these steps will toggle the feature "ON" and "OFF".

8.3 Select Input Source

Press the  (SOURCE) button repeatedly on the soundbar or on the remote control to select the **HDMI eARC/ARC, OPTICAL, , AUX, USB** mode. The selected mode will show on the display.

Display	Mode
ARC	HDMI ARC
E-ARC	HDMI eARC
OPT	OPTICAL
BT BT IN NO BT	Bluetooth • Connected • Not Connected
AUX	AUX
USB NO USB	USB No USB connected

8.4 Adjust the Volume

- Press the **VOL+ / -** buttons on the soundbar or on the remote control to adjust the volume.
- If you wish to turn the sound off, press the  (MUTE) button on the remote control. Press the  (MUTE) button again or press the **VOL+** buttons to resume normal listening.

8.5 Turn the Surround PURE/PRO/OFF

- Press the **SURR** button on the remote control to switch the surround PURE/PRO/OFF.

8.6 Adjust the Bass/Treble

- Press the **BASS + / -** buttons on the remote control to adjust bass level.
- Press the **TREBLE + / -** buttons on the remote control to adjust treble level.

8.7 Select Equalizer (EQ) Effect

- While playing, press the EQ button on the remote control to select desired preset equalizers: **MOVIE, MUSIC, GAME, NEWS, SPORT, NIGHT, AI**.

8.8 Adjust the Brightness

- Press the **DIMMER + / -** buttons on the remote control to select brightness level.

8.9 Factory reset

Reset device to default setting.

- Switch the Soundbar on the optical mode, press and hold the [⏏] button on the Soundbar, the Soundbar will enter factory reset mode and turn to standby state.

MODE	DEFAULT
SOURCE	eARC
Volume	30
Surround	Pure
Dimmer	DIM 3
Bass	0
Treble	0
EQ	MOVIE
Auto Wake	OFF
Auto Standby	ON (Except the USA/Canada/Mexico)

9. HDMI eARC/ARC, OPTICAL, AUX Operation

- 1 Ensure that the Soundbar is connected to the TV or audio device.
- 2 Press the [⏏] (SOURCE) button repeatedly on the Soundbar or on the remote control to select the **HDMI eARC/ARC, OPTICAL, AUX** mode. The selected mode will show on the display.
- 3 Operate your audio device directly for playback features.
- 4 Press the **VOL+ /-** buttons to adjust the volume to your desired level.

Tip: The Soundbar may not be able to decode all digital audio formats from the input source. In this case, the Soundbar will mute. This is NOT a defect. Ensure that the audio setting of the input source (e.g. TV, game console, DVD player, etc.) is set to **PCM** or **Dolby Digital** (Refer to the user manual of the input source device for its audio setting details) with HDMI eARC/ARC / OPTICAL input.

10.USB Operation

- 1 Insert the USB device.

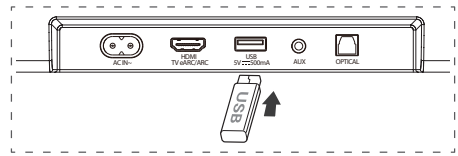

- 2 Press the [⏏] (SOURCE) button repeatedly on the Soundbar or on the remote control to select the **USB** mode.
- 3 During playback:

▶|| Start, pause or resume play

◀◀, ▶▶ Skip to the previous or next track

Tips:

- The unit can support USB devices with up to 32 GB of memory.
- This unit can play WAV / WMA / MP3 / FLAC.
- This product may not be compatible with certain types of USB storage devices.
- If you use a USB extension cable, USB hub, or USB Multifunctional card reader, the USB storage device may not be recognized.
- Do not remove the USB storage device while reading files.

11. Bluetooth® Operation

Through Bluetooth, connect the Soundbar with your Bluetooth device (such as an iPad, iPhone, iPod touch, Android phone, or laptop), and then you can listen to the audio files stored on the device through your Soundbar speakers.

First time pairing

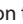
- 1 Press the  (SOURCE) button on the Soundbar or  button on the remote control to select Bluetooth® mode.

The display will show **NO BT**.

- 2 Activate your Bluetooth device and select the search mode.
- 3 Select **"TOSHIBA M310WR"** in the pairing list. The system is successfully connected and the display will show **BT IN**.

- If you want to connect your soundbar with another Bluetooth device, press and hold the  button on the remote control to disconnect the currently connected Bluetooth device. Follow step 2-3 to pair your Bluetooth device.



To disconnect the Bluetooth function, you can :

- Switch to another function on the unit.
- Disable the function from your Bluetooth device.
- Press and hold the  button on the remote control.

Listen to music from Bluetooth Device

- If the connected Bluetooth device supports Advanced Audio Distribution Profile (A2DP), you can listen to the music stored on the device through the player.
- If the device also supports Audio Video Remote Control Profile (AVRCP), you can use the player's remote control to play music stored on the device.





1. Pair your device with the player.
2. Play music via your device (if it supports A2DP).
3. Use supplied remote control to control play (if it supports AVRCP).

	Start, pause or resume play
	Skip to the previous or next track

Tips:

- The operational range between the Soundbar and the device is approximately 8 metres.
- Before connecting a Bluetooth® device to the Soundbar, ensure you know the device's capabilities.
- Compatibility with all Bluetooth® devices is not guaranteed.
- Any obstacle between the device and the Soundbar can reduce operational range.
- Keep this player away from other electronic devices that may cause interference.
- The player will also be disconnected when your device is moved beyond the operational range.

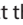
12. Setup Menu

1. During ON mode, press and hold the  button for 3 seconds to open the menu.
 2. Select the content with the  /  buttons.
 3. Change the initial values for each of the settings with **VOL+ / -** buttons.
 4. Press the  button to confirm your selection and exit the settings.
- If no button is pressed within 10 seconds, the system will automatically exit the menu.

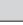
Display  / 	Description VOL+ / -
MOVIE	Select Equalizer (EQ) effect (MOVIE, MUSIC, GAME, NEWS, SPORT, NIGHT, AI)
SUR OFF	Switch Surround Sound SUR PURE / PRO / OFF
BASS	Adjust the Bass Level
TREB	Adjust the Treble Level
DIM3	Adjust the Brightness DIM 0 / DIM 1 / DIM 2 / DIM 3
AUTOWAKE OFF	Switch Auto Wake ON / OFF
AUTO STANDBY ON	Switch Auto Standby ON / OFF
DRC 0	Switch DRC Level 0/1/2
DC 0	Switch Dialog Control Level 0/1/2/3/4/5/6
NEURAL X OFF	Switch Neural : X ON/OFF
VIRTUAL X OFF	Switch Virtual : X ON/OFF
SUB LEVEL	Switch Subwoofer Level -2/-1/0/1/2

13.Troubleshooting

To keep the warranty valid, never try to repair the system yourself. If you encounter problems when using this soundbar, check the following points before requesting service.

Problem	Solution
No power	<ul style="list-style-type: none"> • Ensure that the AC cord of the unit is properly connected . • Ensure that there is power at the AC outlet. • Press ⏻ (standby) button to turn the soundbar on.
Remote control does not work	<ul style="list-style-type: none"> • Before you press any playback control button, first select the correct source. • Reduce the distance between the remote control and the soundbar. • Insert the battery with its polarities (+/-) aligned as indicated. • Replace the battery. • Aim the remote control directly at the sensor on the front of the soundbar.
No sound	<ul style="list-style-type: none"> • Make sure that the soundbar is not muted. Press MUTE or + (VOL) button to resume normal listening. • Press ⏻ button on the soundbar or on the remote control to switch the soundbar to standby mode. Then press the ⏻ button again to switch the soundbar on. • Unplug the soundbar and surround speakers, the subwoofer from the mains socket, then plug them again. Switch on the soundbar. • Ensure the audio setting of the input source (e.g. TV, game console, DVD player, etc.) is set to PCM or Dolby Digital mode while using digital (e.g. HDMI, OPTICAL) connection. • The subwoofer or surround speakers is out of range, please move the subwoofer or surround speakers closer to the soundbar. Make sure the subwoofer or surround speakers is within 5 m of the soundbar (the closer the better). • The soundbar may have lost connection with the subwoofer or surround speakers. Re-pair the units by following the steps on the section “ Pair up with the Subwoofer and Surround Speaker. ” • The soundbar may not be able to decode all digital audio formats from the input source.
TV has display problem while viewing HDR content from HDMI source.	<ul style="list-style-type: none"> • Some 4K HDR TVs require the HDMI input or picture settings to be set for HDR content reception. For further setup details on HDR display, please refer to the instruction manual of your TV.
I can't find the Bluetooth name of this soundbar on my Bluetooth device for Bluetooth pairing	<ul style="list-style-type: none"> • Ensure the Bluetooth function is activated on your Bluetooth device. • Ensure you have paired the soundbar with your Bluetooth device. • The soundbar has a Bluetooth® function that can receive a signal within 8 metres. Keep a distance within 8 metres between the soundbar and your Bluetooth® device.
This is a 15 mins power off function, one of the ERPII standard requirement for saving power	<ul style="list-style-type: none"> • When the unit's external input signal level is too low, the soundbar will be turned off automatically in 15 minutes. Please increase the volume level of your external device.

14. Specifications

Brand	TOSHIBA
Model	M310WR

Soundbar

Power Supply	100-240V~ 50/60Hz
Power Consumption	20 W < 0.5 W (StandBy)
USB	5V \equiv 500mA Hi-Speed USB (2.0) / FAT32 / FAT16 32G (max), WAV / WMA / MP3 / FLAC.
Dimension (WxHxD)	900 x 59.5 x 79 mm / 35.43" x 2.34" x 3.11"
Net weight	2.1 kg / 4.7 lbs
Audio input sensitivity	500mV
Frequency Response	120Hz - 20KHz
Operating Temperature	0°C - 40°C

Subwoofer

Power Supply	100-240V~ 50/60Hz
Power Consumption	25 W < 0.5 W (StandBy)
Dimension (WxHxD)	340 x 155 x 320 mm / 13.39" x 6.1" x 12.60"
Net weight	5.5 kg / 12.2 lbs
Frequency Response	40Hz-150Hz

Wireless Specification (EU)

Bluetooth version / profiles	V 5.4 (A2DP, AVRCP)
Bluetooth frequency range	2400 MHz ~ 2483.5 MHz
Bluetooth Max. transmitting power	\leq 5 dBm
Wireless frequency range	2.4G: 2400 MHz ~ 2483.5 MHz / \leq 5 dBm
Max. transmitting power	5.8G: 5729 ~ 5849/5851 Mhz / \leq 10dBm
Modulation Type	GFSK, $\pi/4$ DQPSK, 8-DPSK

Amplifier (Max Audio Power)

Total	500 W
Soundbar	300 W
Subwoofer	200 W

Remote Control

Distance/Angle	19.7 feet (6m) / 30°
Battery type	AAA (1.5V x 2)

- Design and specifications are subject to change without notice.

Trademarks



The Bluetooth® word mark and logos are registered trademarks owned by Bluetooth SIG, Inc. and any use of such marks by The HISENSE International Industries, Incorporated is under license. Other trademarks and trade names are those of their respective owners.



The terms HDMI, HDMI High-Definition Multimedia Interface, HDMI trade dress and the HDMI Logos are trademarks or registered trademarks of HDMI Licensing Administrator, Inc.



Dolby, Dolby Atmos, and the double-D symbol are registered trademarks of Dolby Laboratories Licensing Corporation. Manufactured under license from Dolby Laboratories. Confidential unpublished works. Copyright © 2012-2024 Dolby Laboratories. All rights reserved.



Manufactured under license from DTS, Inc. and/or its affiliates. For patents, see <https://xperi.com/dts-patents/>. DTS, the DTS logo, DTS:X, the DTS:X logo, Virtual:X, and the DTS Virtual:X logo are trademarks or registered trademarks of DTS, Inc. and/or its affiliates in the U.S. and/or other countries. © DTS, Inc. and/or its affiliates. All rights reserved.





WARNING: This product can expose you to chemicals including Lead, which is known to the State of California to cause cancer. For more information go to: www.P65Warnings.ca.gov.



FR

EN

Règlement de la FCC (pour les clients américains)

FCC INFORMATION (for US customers)

NOTE:

- This equipment has been tested and found to comply with the limits for a Class B digital device, pursuant to Part 15 of the FCC Rules. These limits are designed to provide reasonable protection against harmful interference in a residential installation. This equipment generates, uses and can radiate radio frequency energy and, if not installed and used in accordance with the instructions, may cause harmful interference to radio communications.
- However, there is no guarantee that interference will not occur in a particular installation. If this equipment does cause harmful interference to radio or television reception, which can be determined by turning the equipment off and on, the user is encouraged to try to correct the interference by one or more of the following measures:
 - Reorient or relocate the receiving antenna.
 - Increase the separation between the equipment and receiver.
 - Connect the equipment into an outlet on a circuit different from that to which the receiver is connected.
 - Consult the dealer or an experienced radio / TV technician for help.

This device complies with Part 15 of the FCC Rules. Operation is subject to the following two conditions:

- (1) this device may not cause harmful interference, and
 - (2) this device must accept any interference received, including interference that may cause undesired operation.
- Shielded cables must be used with this unit to ensure compliance with the Class B FCC limits.

IC Notice: CAN ICES-3(B)/NMB-3(B)

This device contains licence-exempt transmitter(s)/receiver(s) that comply with Innovation, Science and Economic Development Canada's licence-exempt RSS(s). Operation is subject to the following two conditions:

1. This device may not cause interference.
2. This device must accept any interference, including interference that may cause undesired operation of the device.

Warning:

- This equipment should be installed and operated with minimum distance 20cm between the radiator & your body.
- Changes or modifications to this unit not expressly approved by the party responsible for compliance could void the user's authority to operate the equipment.*

REMARQUE :

- Ce dispositif a été testé et déclaré conforme aux limites d'un dispositif numérique de classe B, conformément à la partie 15 des règles de la FCC.
Ces limites ont pour but d'assurer une protection raisonnable contre le brouillage nuisible dans une installation résidentielle. Cet équipement produit, utilise et peut émettre de l'énergie en radio fréquence et, s'il n'est pas installé et utilisé conformément aux directives, il peut causer un brouillage nuisible dans les communications radio.
- Cependant, il n'est pas garanti que des interférences ne se produiront pas dans une installation particulière. Si cet appareil provoque des interférences nuisibles à la réception radio ou de télévision, ce qui peut être déterminé en mettant l'appareil hors tension, l'utilisateur est encouragé à essayer de corriger l'interférence par une ou plusieurs des mesures suivantes :
 - Réorienter ou déplacer l'antenne de réception.
 - Augmenter la distance entre l'appareil et le récepteur.
 - Brancher l'appareil à une prise sur un circuit différent de celui sur lequel le récepteur est branché.
 - Consulter le revendeur ou un technicien radio/TV expérimenté.

Cet appareil est conforme à la partie 15 des règles de la FCC. Son fonctionnement est soumis aux deux conditions suivantes :

- (1) ce dispositif ne peut pas causer d'interférences nuisibles et
 - (2) cet appareil doit accepter toute interférence reçue, y compris les interférences qui peuvent causer un mauvais fonctionnement.
- Des câbles blindés doivent être utilisés avec cet appareil pour assurer la conformité avec les limites de la classe B de la FCC. fonctionnement de l'appareil.

Avis d'Industrie Canada: CAN ICES-3(B)/NMB-3(B)

L'émetteur/récepteur exempt de licence contenu dans le présent appareil est conforme aux CNR d'Innovation, Sciences et Développement économique Canada applicables aux appareils radio exempts de licence. L'exploitation est autorisée aux deux conditions suivantes :

1. L'appareil ne doit pas produire de brouillage;
2. L'appareil doit accepter tout brouillage radioélectrique subi, même si le brouillage est susceptible d'en compromettre le fonctionnement.

Avvertissement :

- Pour rester en conformité avec les consignes d'exposition aux RF, placez le produit à au moins 20 cm des personnes proches.
- Les changements ou modifications de cet appareil non expressément approuvées par la partie responsable de la conformité pourraient annuler l'autorisation de l'utilisateur à utiliser l'équipement.

TOSHIBA

M310WR



08855

Made in China